

Special and Innovative Equipment

High frequency welding line / Lighting pole profiling line /
Curving machine for lighting poles and various profiles /
Production line for decorative & high resistance poles (HSP) /
Steel lattice tower production line

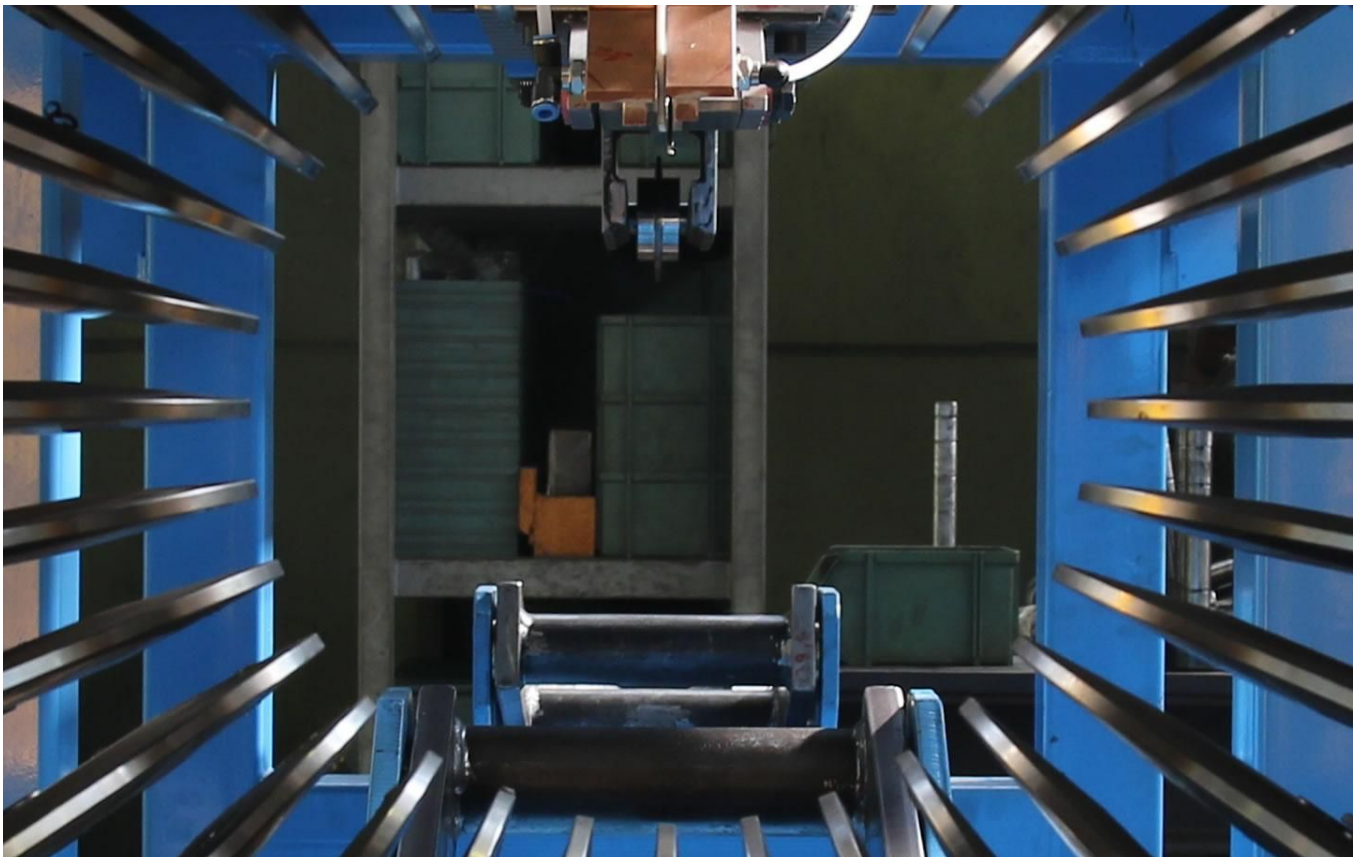

Dear Sirs,
we thank you for the preference granted and cheerful to inform You regarding the business of our Company.

For all manufacturing automated production line related to steel components and process as handling, welding, assembly, bending, roll forming and similar processes, OMM can offer full know-how for the turnkey supply of all required equipment and customized solutions. We selected for you some of them:

- ☒ High frequency welding line;
- ☒ Lighting pole profiling line;
- ☒ Curving machine for lighting poles and various profiles;
- ☒ Production line for decorative & high resistance poles (HSP);
- ☒ Steel lattice tower production line.

Keys benefits of our special & innovative equipment



Efficiency

Continuous high-quality production.



Performance

Fully automated solutions with high production rate and lowest number of operators.



Time to market

Short & guaranteed time to market.



Turnkey

Turnkey solution without worries for a certain result.

With regard to the steel poles industry, road accessories, train manufacturing, car plate number, steel lattice tower, military and other, the high technical know-how gained in design and production activities and our long-standing experience in this field of application enable OMM to provide important brevets and innovations for the manufacturing processes.





OMM has provided highly innovative production solutions to the leading producers of those products in Italy as well on the international market as:

Tecnopali | Siderpali | N.C.M. | Petrucci Pali | Sites | F.lli Campion | Ferrovie dello Stato | Sanmarco | Firema | FIAT | Ansaldo | Alenia | SOGECO | New Holland | IMeva | Fiat Aviazione | Morteo Container | Fincantieri | Stam | Ferbona | Allied | Fiat Ferroviaria | Spiro Italia | Philips Sud S.p.a. | Tubosider | Ital Tractor | Lear | Bode | IPZS | General Electric | Avdeevka | Al Babtain | Al Jaber | Formet | Kromiss-Bis | Valmont | metako | Energostalkonstruksia | Umecon | Socintech | Amiga | Al Yamamah | Galva Coat | Rouiba Eclairage and more.

The purpose of OMM is to meet the ever-increasing demand for highly specialized industrial automatic systems, by assisting the foreign companies in modernization and expansion of their production processes either through strategic cooperation for research customized design and handing over of special production equipment.

The OMM's philosophy is to optimize and increase the production with high automation process and appoint the checking phase to a man.

All of our equipment is supplied directly to the client, complete with a tailor made, highly articulate, maintenance and after-sales assistance program, together with a staff-training package on demand.



Some of our innovative and customized production lines

HIGH FREQUENCY WELDING LINE

Line able to weld at high speed lighting poles with not visible welded joint.



OMM provide wide and flexible solutions by its new high frequency welding line with high welding speed and quality, high productivity, reduced floor foot print and aesthetical welding joint that make very convenient and suitable this machine for poles production plant with high production rate and high-quality demand.

OMM's high frequency welding line can easily be operated and carried thanks to its user-friendly interface. It's produced with latest production technologies able to guarantee the best results in term of poles welding.



Used for steel poles production, represent the solution for companies that wants to produce poles with very high quality and high production rate, to be successfully on the lighting pole market.

OMM's high frequency welding line realize the welding of conical round poles with a high frequency welding technology. The machine automatically, through its dedicated bridge crane, feed the line, weld the joint, remove the exceeding external welding and straight the pole simultaneously to the welding phase realizing a pole perfectly straight and with high aesthetical quality.

After the galvanizing is not possible to distinguish the welding area. All the process is managed by only one operator for parameters setting and survey, is fully automated without any pole manipulation. Make a good pole in a very short time it's the first condition to be the first on the market of lighting poles and to increase the profit.

LINE FOR DECORATIVE & HIGH RESISTANCE POLES WITHOUT WELDING (HSP – HOT SPUN POLE)

Decorative & high resistance poles, without welding, starting from commercial pipes.



OMM provide wide and flexible solutions by its latest HSP production line with hot roller forming accuracy and quality, the make convenient this machine for poles production plant that want to cover a wide range of pole typology suitable for urban street light & decoration poles.

OMM's HSP production line can easily be operated and carried thanks to its user-friendly interface. It's produced with latest production technologies able to guarantee the best results in term of Hot Spun Poles.



Used for decorative & high resistance poles production, represent the solution for companies that wants to produce poles with good quality and roll formed cross section, starting from commercial pipes. This machine allows, starting from a wide range of cylindrical pipe, practically, infinite series of poles can be obtained by hot rolling forming. The shape become set through software and realized by CNC. OMM's HSP production line is suitable for the production of conical round poles (axial symmetrical) for urban street light, lighting poles, tapered poles and high mechanical resistance poles for tramway application. This system uses a hot rolling forming technology starting from pipes as per standard EN10305 – BS6323P5.

One of the main features of this machine is the capability also to remove the exceeding welding, that mean after this machine will be no possible to distinguish the joint.

OMM's HSP production line after the operation guarantee a uniform thickness, equal to the starting thickness, along all the roller formed length. Furthermore, for special production, there is a possibility to have a small thickness reduction, in progressive way along all the roller formed length.

LIGHTING POLE PROFILING LINE

Line able to produce lighting poles by roll forming, starting from trapeziums.



OMM provide innovative, special and flexible solutions by its new lighting pole profiling line with high production rate and very innovative way of producing shells that make very convenient and suitable this machine for poles production plant with high production rate.

OMM's lighting pole profiling line can easily be operated and carried thanks to its user-friendly interface. It's produced with latest production technologies able to guarantee the best results in term of poles welding.

Used for steel poles production, represent the solution for company that wants to produce poles with very high quality and high production rate, to be successfully on the lighting pole market.

OMM's lighting pole profiling line realize the profiling of conical round poles starting from trapeziums without the use of press brake. The machine automatically, through its dedicated bridge crane, feed the line, profile the trapezium and make the poles ready to be welded.

All the process is managed by only an operator for parameters setting and survey, is fully automated without any sheet manipulation. The line needs another operator for trapezium pack loading. OMM's lighting pole profiling line change completely the poles production process doesn't use anymore the hydraulic press brake for the sheet bending and reduce considerably the shell production cycle time. This is machine is suitable to work in line with the high frequency welding line due to the high production rate.



CURVING MACHINE FOR LIGHTING POLE AND VARIOUS PROFILE

Poles & various profile curving, starting from straight profiles.



OMM provide wide and flexible solutions by its new profile curving machine with fast and high curving quality that make suitable this machine for poles production plant oriented on poles & profile design.

The machine is able to curve, various profiles as conical round poles, poles arms, or profiles with different section (i.e. I, L, C, U, etc.), against rollers & clamping tools change.

OMM's profile curving machine can easily be operated and carried thanks to its user-friendly interface. It's produced with latest production technologies able to guarantee the best results in term of profile curving.

Used for steel poles & various profile curving, represent the solution for company that wants to produce poles and/or profile with design impact, with good bending quality, starting from straight profiles.



OMM's profile curving machine is composed by a profile carriage and shaped, CNC controlled rollers. That represent the core of the machine.

The machine can be supplied with a loading and unloading system to manage the cycle completely in automatic.

Steel lattice towers (transmission pylon) production line

Steel lattice towers for power transmission up to 500 KV / Communication towers – Square & triangular / Radio mast towers / TV and aerial masts / Substation structures / Gantries

STEEL LATTICE TOWERS (TRANSMISSION PYLON) PRODUCTION LINE



OMM provide wide and flexible solutions by its equipment to realize the steel lattice towers. OMM's lattice towers production line can easily be operated and carried thanks to its user-friendly interface.



Used for steel lattice tower production (and for other application), represent the core machine for companies that wants to produce lattice towers with high quality, repeatability, large production volume and all in one machine/line passing over the old concept of production that use different machine and not one full automated production line.

By beams:

The cycle starts with beam pick up thanks to a partner that help the operator to put it on the roller conveyor. The beam pass through a shearing machine that perform a cut to length and after that the beam is moved, with another roller conveyor, up to reach the bridge crane that take the beam and put it on a step by step conveyor.

The line includes different punching units able to perform the different holes and slots forecasted by the design. The beams after the operation go out from the punching units by a roller conveyor and become packed with a bridge crane. The beams pack become stored in a chain conveyor, ready to be picked up by the forklift or plant bridge crane, for further operations.

By beams pack:

The line working modality and final result are the same. The main and only difference is that the line starts from beams pack and that the line needs only one operator for its management. The process starts with the loading of the beams pack on to the input roller. The pack is referred and clamped to be cut to length. After cutting the pack arrive, through another roller conveyor on the following station (bridge crane) to be destocked, one by one, and each beam will feed the line for further operation of punching as above described.

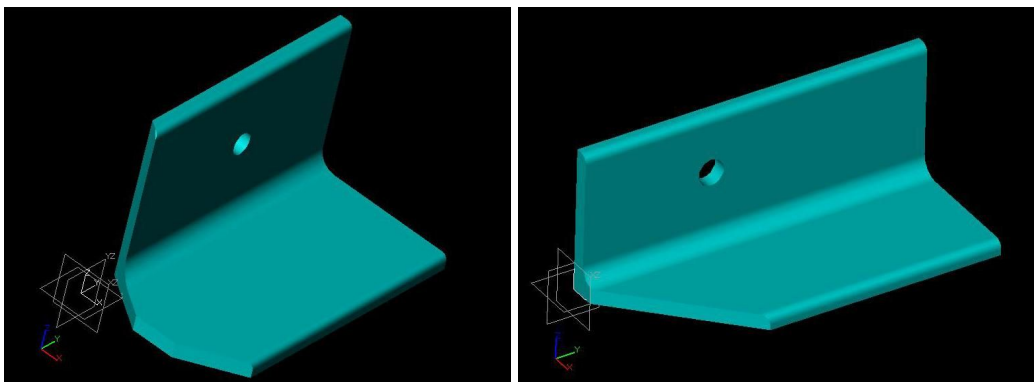

All our systems has been designed and manufactured respecting all the norms, in term of safety and respecting the environment (noise, fumes aspiration, energy recovery back), given by the European Community:

- ☒ Complies with all applicable requirements of the machine directive 2006/42/EC
- ☒ Conforms with all applicable provisions of the directive 2006/95/CE (low tension)
- ☒ Conforms with all applicable provisions of the directive 2004/108/CE (electromagnetic compatibility)
- ☒ Conforms with the standard EN ISO 12100 (General principles on machine design)
- ☒ Conforms with the standard EN 60204 (Machine Electrical Equipment)

OMM implement the management system in conformity with the European norm ISO 9001:2015 for the designing, construction, installation and maintenance of the industrial automatic equipment for steel fabrication (EA 18).

We are at Your complete disposal for any needs.
Thanks for your attention, best regards.

Nicola Di Tullio
CEO

