

*We have been focusing on your goals  
for 40 years*

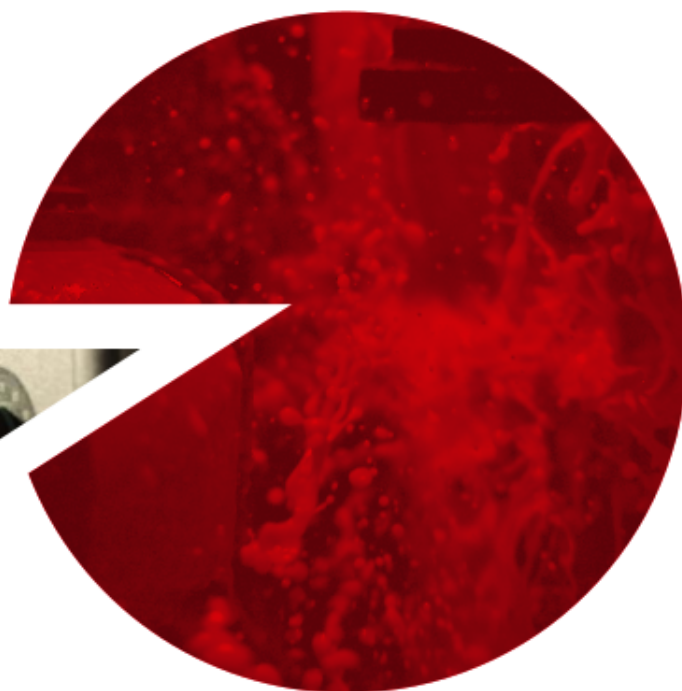

**GENERAL CATALOG**  
GEAR HOBGING MACHINES/BORING MACHINES/CHROMED SHAFT MACHINES  
CENTRING-FACING MACHINES / CUSTOMIZED MACHINES

**menti**  
MACHINE TOOLS



40 years of passion  
for machine tools



**ment**  
MACHINE TOOLS

## MENTI MACHINE TOOLS. A PASSION THAT HAS BEEN GOING ON FOR 40 YEARS

Everything comes from a deep interest in CNC machine tools, by the founder of M Services Srl, Mr. Gianantonio Menti, which has become, over the years, the reference point for small and medium-sized companies, in automotive, mechanical and agricultural sectors. Innovation, research and development allowed M Services Srl, to design and realize new special machine lines, proposing customized solutions. Today it presents itself on the market with a new brand: Menti Machine Tools.





## FROM DESIGN TO QUALITY CONTROL, TO HAVE A MACHINE AT THE TOP.

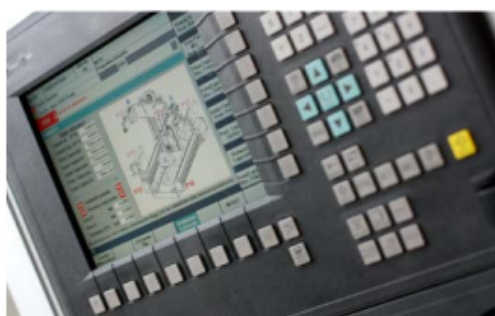
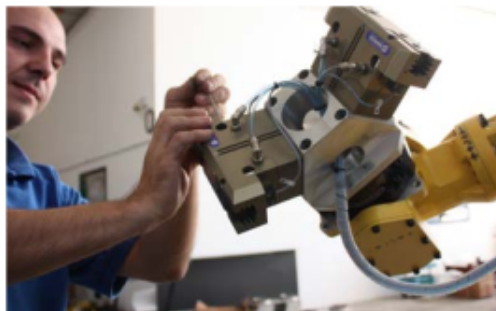

Our robust machines, designed for gear hobbing, chromed shafts processing, boring and center-facing, are assembled with high-quality electronic and mechanical components. All the mechanical components are controlled inside an equipped metrological room, from the processing up to the mounting in the machine.

Our goal is to guarantee at customers an ever increasing quality and reliability of the machines, through a continuous research and development for the realization of new products.

### IN SUMMARY

- Technical advices, analysis and feasibility study of the project, on the base of customer's productions needs, all through our high qualified staff.
- Technical assistance on site from our specialized technicians.
- After sales service, with quick supplying of spare parts.
- Telephone assistance with our qualified staff.
- Remote assistance on enabled machines of our production.

Certified company  
UNI EN ISO 9001:2015





## OUR SOLUTIONS TO YOUR NEEDS.

Our design office follows the customer from the analysis, to 3D feasibility study of the project, until the realization of the machine.

We organize targeted and customized training courses on the functionality of our machines, during installation and their use. We also arrange programming courses for customers, on CNC Siemens and Fanuc.

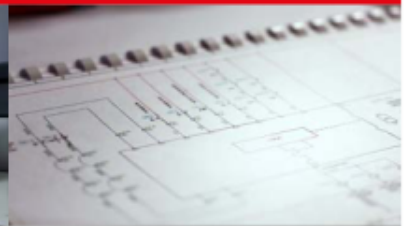



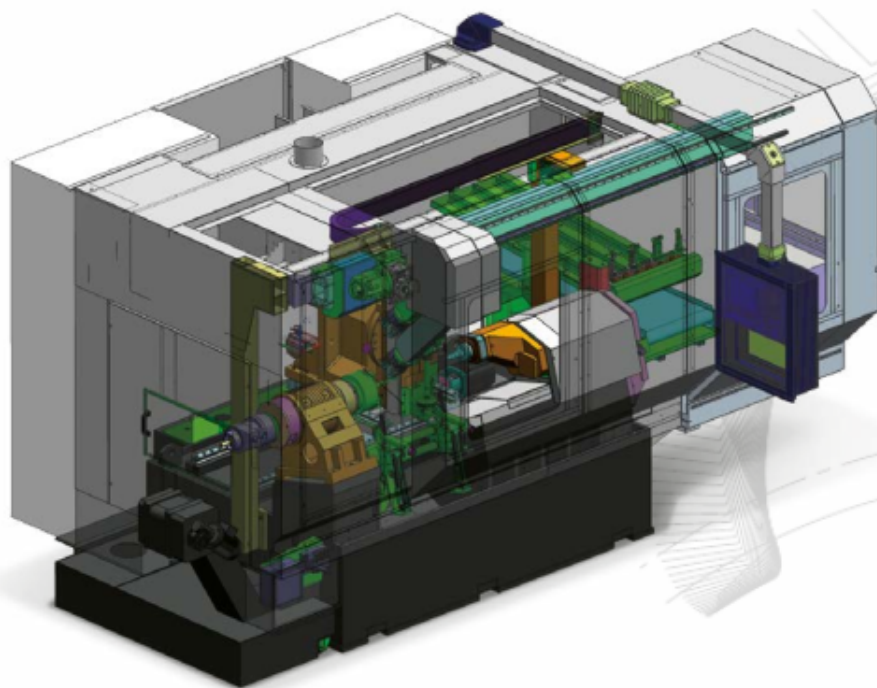

## AESTHETIC AND FUNCTIONALITY, SIMPLY OUR STRENGTH.

Our machines are designed and studied in the smallest details, in order to be reliable in performance and to last over time. It's an idea that takes the form of a project, planned to get the best of functionality from a machine, at the service of our customers.

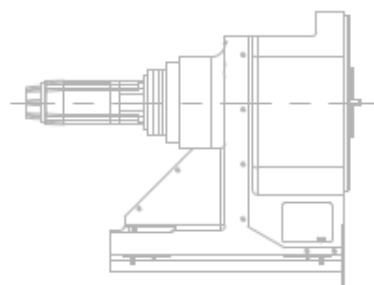
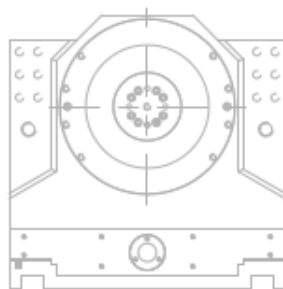

## OTHER SERVICES



### C.N.C. MACHINES OVERHAUL

We overhaul customer's machines, according to its indications, operating in: complete or partial replacement of the CNC electrical system; replacement of mechanic, hydraulic and pneumatic machine parts; installation of new updated software and machinery painting.



### TECHNICAL ASSISTANCE AND SPARE PARTS.

We guarantee assistance ,on-site and by telephone, on CNC machines and industrial automation of any type (mechanical, electrical, electronical and software problems), on machines both of our production and imported. Our specialized team has specific tasks and it's properly trained and updated on the use of new software.



### MACHINE HANDLING AND INSTALLATION.

We follow the customer from handling to repositioning the machine inside their company structure. We have specific equipment that allows the movement of machinery in complete safety and we also support the customer even during the commissioning and leveling of the machine, with efficiency control.

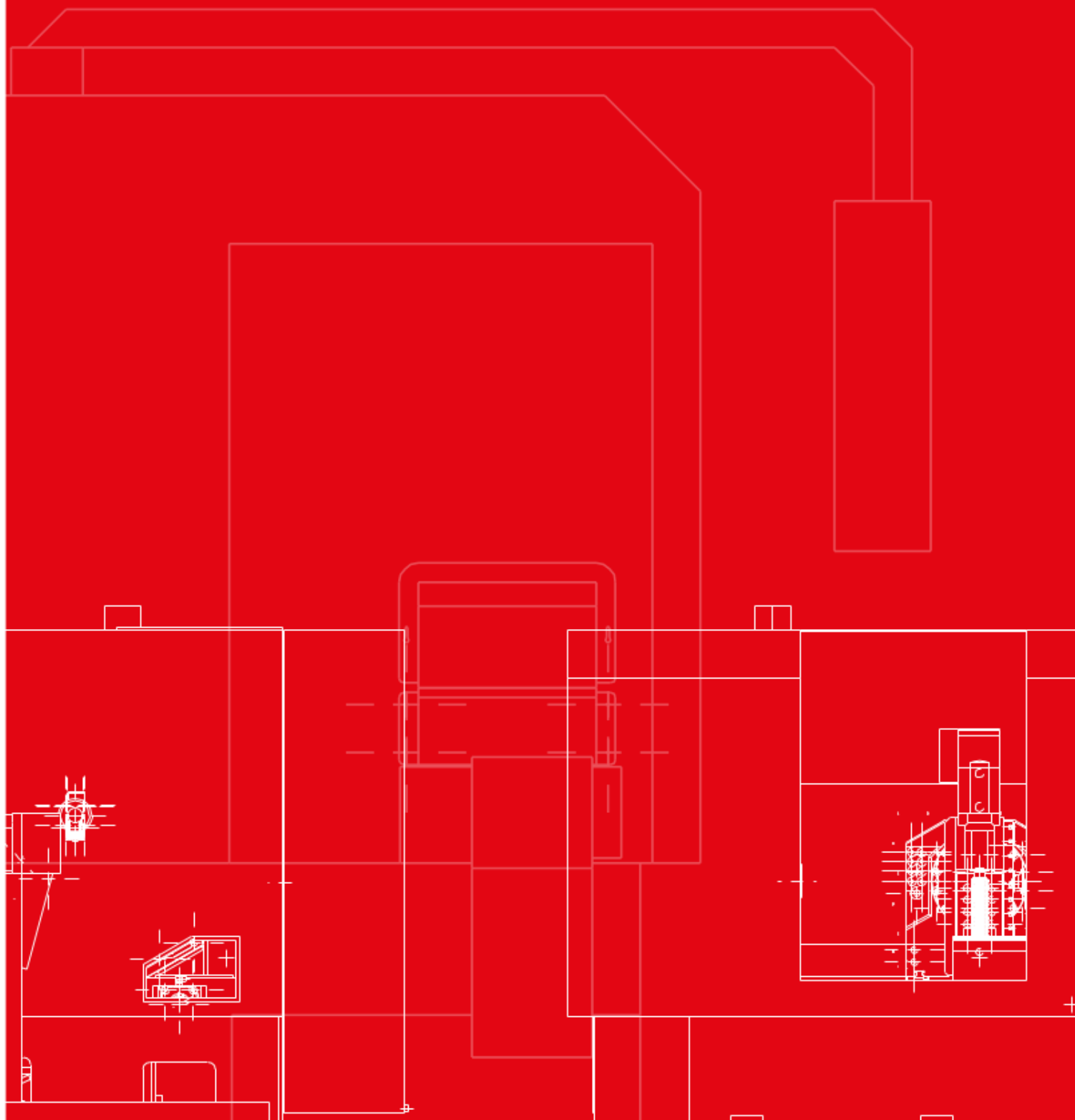

MENTI MACHINE TOOLS  
**THE RANGE**



GEAR HOBBLING MACHINES

BORING MACHINES

CHROMED SHAFT MACHINES

CENTRING-FACING MACHINES

CUSTOMIZED MACHINES

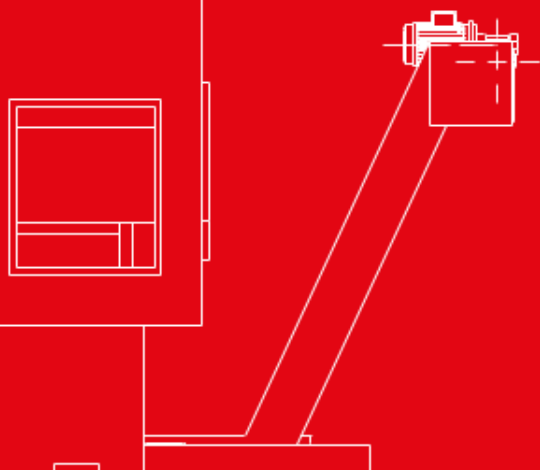



# GEAR HOBBIING MACHINE **DM 4.0**

High performance and maximum precision machine.  
Great for medium/high productions.



Representative images, version with loader

- Horizontal CNC gear hobbing machine, designed for the machining of small and medium gears, it can be equipped to mill endless screws thanks to the high tilt angle of the tool axis.
- Its rigid structure and assembly with high-quality materials, allow a longer duration of cutting tool, ensuring greater production with a single sharpening
- Easy to equip and highly versatile to adapt to the customer's equipment
- Software realized by us. It is simple, complete and intuitive and it can be adapted or implemented on specific requests.
- It can be supplied with an optional customizable loading and unloading system.
- Remote assistance, installable on request.

## DETAILS

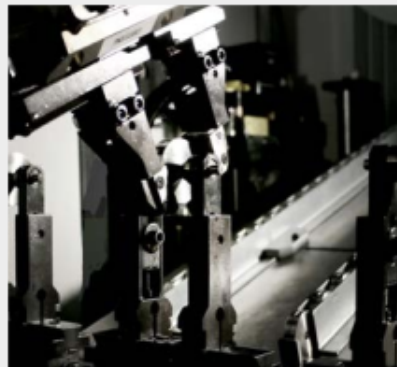

Some processing details

# DATA SHEET

## GEAR HOBBING MACHINE DM 4.0

Machine	
Max. diameter workpiece	Ø 140
Max. length workpiece	400 mm
Max. hobbing module	3
Min-max. distance between centers	10/120 mm
Axial travel (Z)	300 mm
Radial travel (X)	110 mm
Hob head	
Max. diameter hob	120 mm
Max. length hob	180 mm
Shift stroke (Y)	160 mm
Speed milling cutter (S)	4000 RPM
Swivel angle (A)	+ 45° - 45°
Spindle nose	cylindrical
Spindle torque	60 Nm
Slide	
Slide speed rotation	850 RPM
Slide bore	Ø 48
Slide torque	170 Nm
Axes	
Axis Z	15.000 mm/min
Axis X	15.000 mm/min.
Axis Y	5.000 mm/min.
Tailstock	
Tailstock travel (W)	300 mm
Max. power boost	750 daN

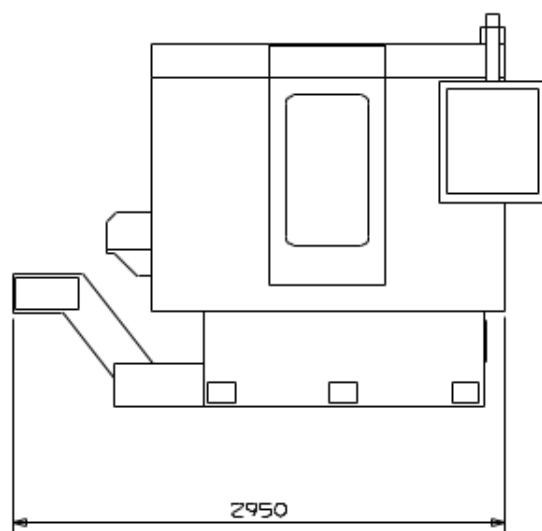

Version without loader

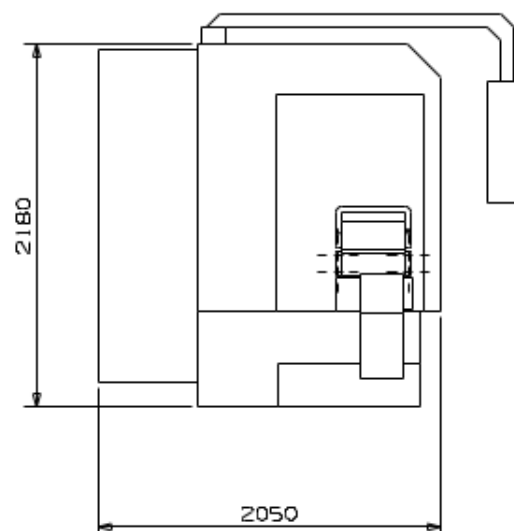

weight 6.400 Kg



Some examples of pieces made

# GEAR HOBBIING MACHINE **DM 6.0**

Great compromise between power and dynamism.



- Horizontal CNC gear hobbing machine intended for small and medium sized hobbing, ideal for gears and splined shafts
- Thanks to the distance between the guides and the tool axis, it can housing moldings with an high geometric bulk, allowing the table to rotate freely.
- The solid structure ensures the best production standards and a longer duration of cutting tool, allowing continuity of production and a significant increase in hourly profitability
- The strength of this machine is the versatility of adapting to the customer's equipment for each individual production code.
- The high shift stroke allows the housing of different combinations of tools and the realization on the single workpiece of multiple hobbing with a single set-up, without repositioning.
- The height of the table and the wide sliding doors are designed to allow an easy access to the operations of tooling or replacing workpieces.
- Software realized by us. It is simple, complete and intuitive and it can be adapted or implemented on specific requests.
- It can be supplied with an optional, customizable, double-arm loading and unloading system
- Remote assistance, installable on request.

## DETAILS



Some processing details

# DATA SHEET

## GEAR HOBBING MACHINE DM 6.0

Machine	
Max. diameter workpiece	Ø 300
Max. length workpiece	600 mm
Max. hobbing module	5
Min-max. distance between centers	10/120 mm
Axial travel (Z)	600 mm
Radial travel (X)	190 mm
Hob head	
Max. diameter hob	135 mm
Max. length hob	270 mm
Shift stroke (Y)	250 mm
Speed milling cutter (S)	2000 RPM
Swivel angle (A)	+ 45° - 45°
Spindle nose	cylindrical
Spindle torque	81 Nm
Slide	
Slide speed rotation	450 RPM
Slide bore	Ø 68
Slide torque	430 Nm
Axes	
Axis Z	12.000 mm/min.
Axis X	12.000 mm/min.
Axis Y	5.000 mm/min.
Tailstock	
Tailstock travel (W)	500 mm
Max. power boost	750 daN

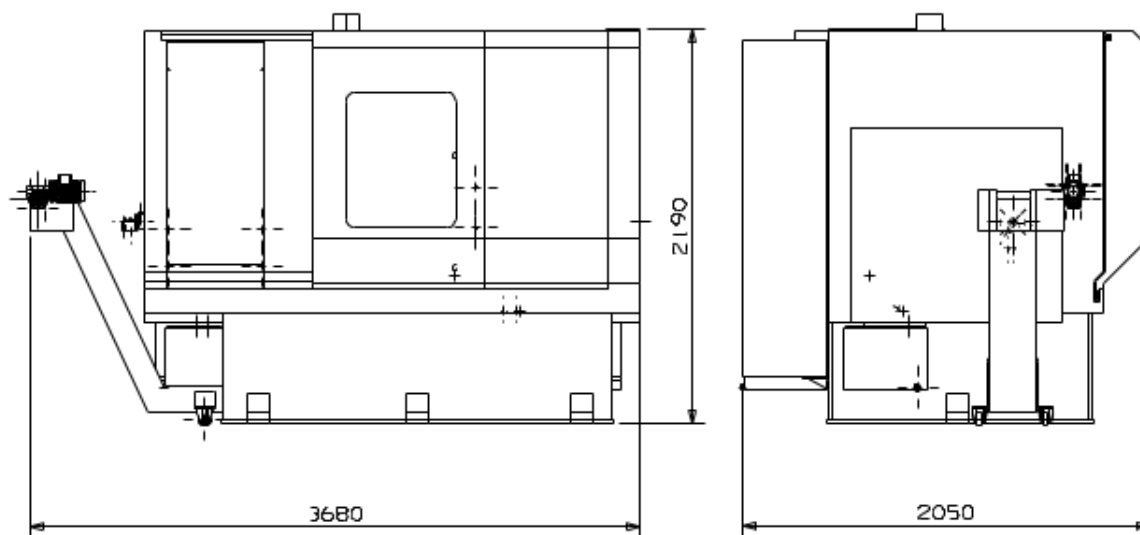

weight 8.300 Kg



Some examples of pieces made



# GEAR HOBBIING MACHINE DM 8.0

Robust guides and torque motors  
for precision machining.



- Horizontal CNC gear hobbing machine designed for hobbing up to module 5. Solidity and power are ensured by large guides and torque motors, for all types of hobbing.
- Detailed research on locking systems has improved the cutting hob duration, ensuring repeatability, precision and rigidity.
- The shifting axis allows the housing of several tools and it is managed to optimize the cooling down and consumption of the cutting tool.
- With the optional effort control and the quick tool release in case of excessive wear, emergency or power failure, the hob is preserved from expensive breakages
- The height of the table and the wide sliding doors are designed to allow an easy access to the operations of tooling or replacing workpieces.
- The slide can be equipped with all standard or customized dragging systems.
- Software realized by us. It is simple, complete and intuitive and it can be adapted or implemented on specific requests.
- It can be supplied with an optional, customizable, double-arm loading and unloading system
- Remote assistance, installable on request.

## DETAILS

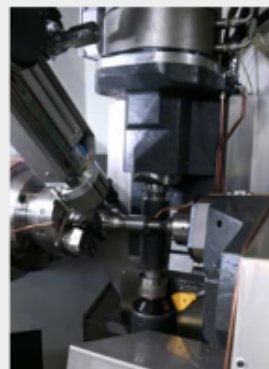
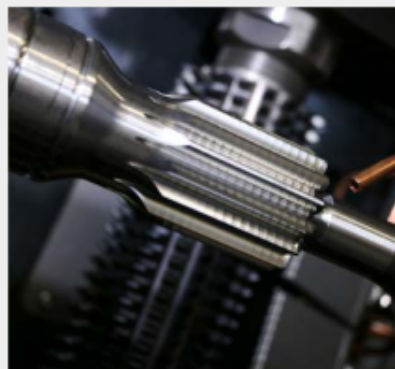
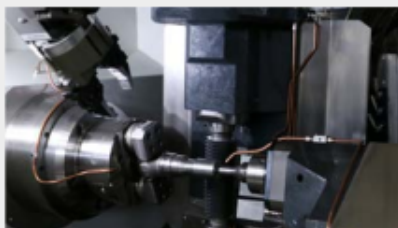

Some processing details



# DATA SHEET

## GEAR HOBBING MACHINE DM 8.0

Machine	
Max. workpiece-diameter	Ø 220
Max. workpiece length	600 mm ( 1000-2000 optional)
Max. hobbing module	8
Min-max. distance between centers	10/160 mm
Axial travel (Z)	600 mm
Radial travel (X)	150 mm
Hob head	
Max. diameter hob	135 mm
Max. length hob	270 mm
Shift stroke (Y)	250 mm
Speed milling cutter (S)	1200 RPM
Swivel angle (A)	+ 45° - 45°
Spindle nose	cylindrical
Spindle torque	450 Nm
Slide	
Slide speed rotation	200 RPM
Slide bore	Ø 68
Slide torque	860 Nm
Assi	
Axis Z	12.000 mm/min.
Axis X	12.000 mm/min.
Axis Y	5.000 mm/min.
Tailstock	
Tailstock travel (W)	500 mm
Max. power boost	750 daN

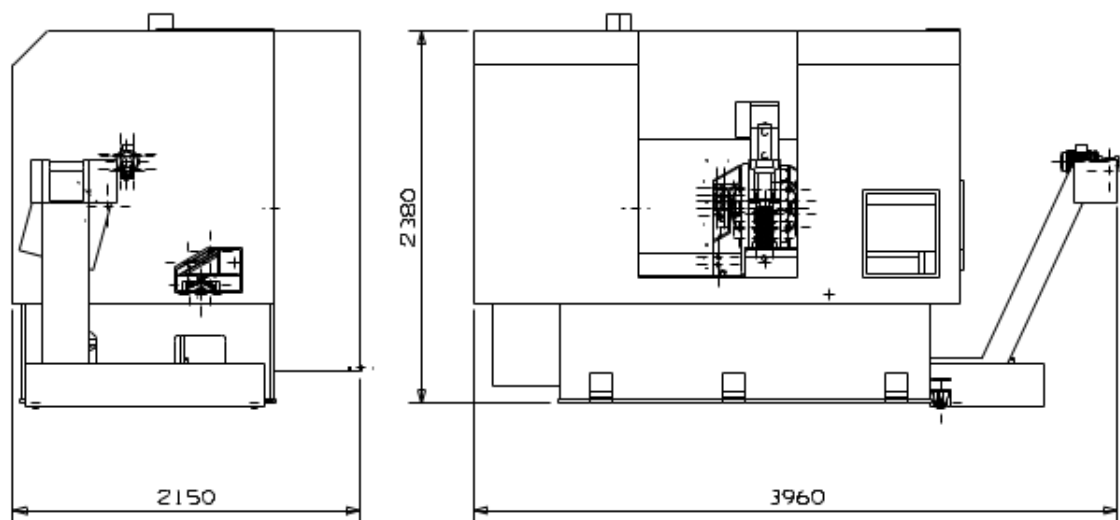

weight 10.500 Kg



some examples of details made

## BORING MACHINE **TSB3**

A machine designed to work opposing holes and "T" junctions

The boring machine is simple to program and to use; it works the inner hole of hydraulic cylinders snodes junctions, with diameters from 20 mm until 300 mm.

The processing takes place with clamped piece and rotating tools on two opposing units.

The machine, arranged to be adjusted either manually or automatically, has got an electrically welded and normalized carpentry base.

The C.N.C. boring -holder devices allow processing of multiple diameters, on the same workpiece, chamfers and internal or external thread.

During processing, the TSB3 has got a work bench with adjustable supports, based on the size of the workpieces.

The hydraulic self-centering vise ensures the perfect orthogonality of machining; the loading and unloading are done manually, by the operator.

## SPECIAL MACHINE FOR CHROMED SHAFTS **TB412Y**

A machine designed to optimize tooling and programming times



The CNC machine TB412Y is designed for the processing of chromed shafts for hydraulic and pneumatic cylinders.

It is equipped with a loading station on self-positioning rollers, able to receive bars from diameter of 12 mm up to 110 mm, variable from a length of 150 mm up to 3000 mm.

Ground pliers and micro filtered refrigeration allows machining of shafts without damages of the chrome surface.

The 12-position motorized turret, on which up to 24 tools can be installed, has got an Y axis for milling and holes machining, also off-axis.

The unload of the workpiece from the counter - spindle is totally automatic.

The simplicity of its use and the high versatility, make the lathe TB412Y an extremely competitive machine, making it possible whoever to realize quickly any kind of chromed bar.

The software, which we realize, is structured in order to be able to perform the operations from customizable data tables according to the needs of the final customer.





## CENTRING-FACING MACHINES

The new generation of machine  
for End-processing

The centring-facing machines are designed to meet the demand for higher flexibility, precision and simplification, on the processing of heading and centring of small and large productions, combining great power and high stiffness, allowing also to integrate an automatic loading / unloading system.

The base is an electro-welded and normalized steel structure. The use of self-centering clamps, fixed on linear guides for the movement of the slides, make it possible to block the pieces of considerable consistency, also including a wide range of fixing diameters.

Two opposing working units are used: each unit can be supplied with an additional optional spindle for tapping, or for other processing, and all operations are performed in a single grip.

The use of a touch screen operator panel with easy programming ensures versatility and simplicity of application, making simultaneous machining possible on both ends.

The machine is provided with a total enclosure and sliding doors interlocked by a safety switch and it is also predisposed for connection to robots or other types of automation for workpiece loading / unloading.



## SPECIAL MACHINES

Menti Machine Tools develops also special machines customized to specific needs.

We are able to design and realize special CNC machines on specific production needs.

One of our strengths is the construction of customized CNC machines.

On demand, we study equipment to be implemented on existing machines, in order to automate their production. In this, the company relies on the design office, which follows the customer from the analysis, to 3D feasibility study of the project, until the realization of the machine.

detailed and updated info on  
[www.mentimachinetools.com](http://www.mentimachinetools.com)

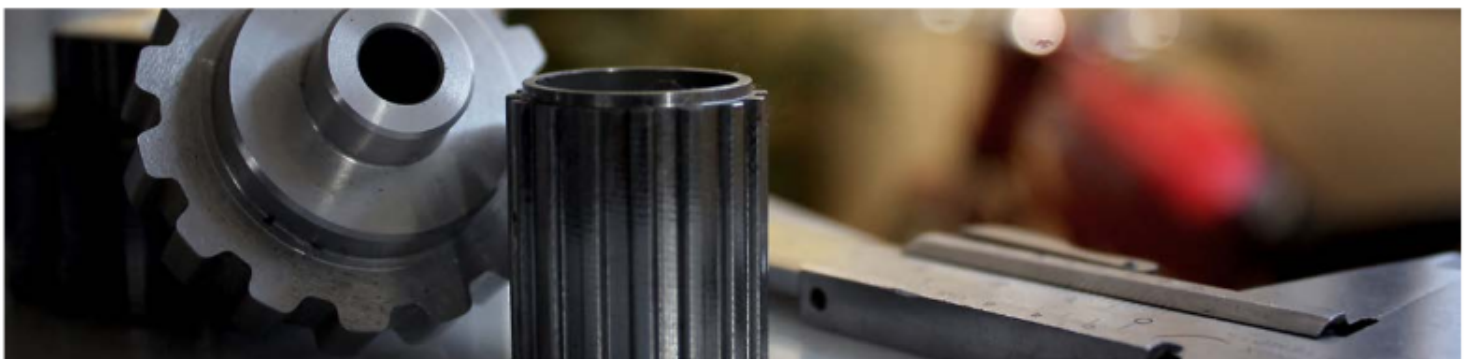
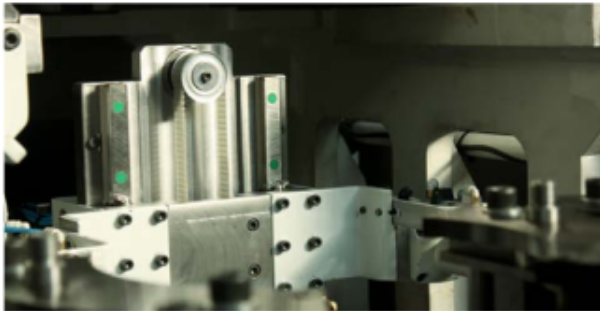
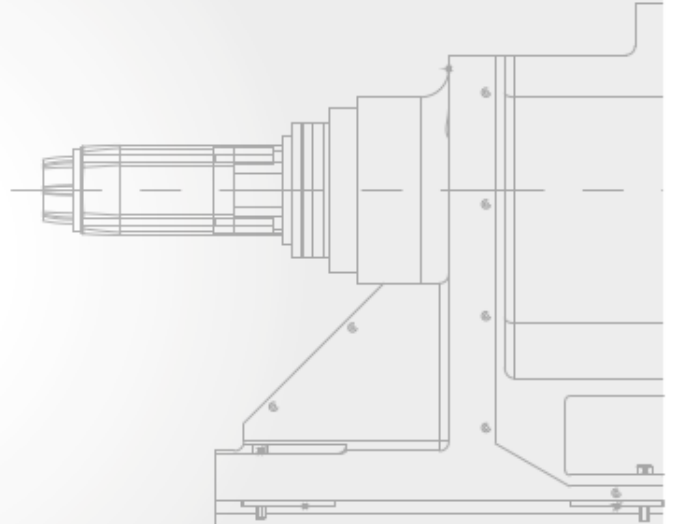



The technical data and product characteristics in this catalogue are understood as indicative and non-binding.  
Therefore, M Services reserves the right to modify them at any time, without notice.  
The technical drawings and information contained in this document are owned by M Services Ltd.  
Rights reserved for legal terms.  
Menti Machine Tools /M Services Srl

**menti**  
MACHINE TOOLS



[www.mentimachinetools.com](http://www.mentimachinetools.com)





GEAR HOBBING MACHINES  
BORING MACHINES  
CHROMED SHAFT MACHINES  
CENTRING-FACING MACHINES  
CUSTOMIZED MACHINES



Menti machine tools  
is a brand of M Services Srl

**M Services s.r.l.**  
Via Silvio Pellico, 6  
36075 Montebelluna Maggiore (Vicenza) Italy  
Tel. +39 (0)444 653004 - Fax. +39 (0)444 695123  
info@mentimachinetools.com  
[www.mentimachinetools.com](http://www.mentimachinetools.com)