



ITALIAN TRADE AGENCY

ICE - Agenzia per la promozione all'estero e
l'internazionalizzazione delle imprese italiane

COVERINGS 2020

23-23 april

New Orleans

PROGETTO PILOTA AREA BENI STRUMENTALI

ITALIAN PAVILION



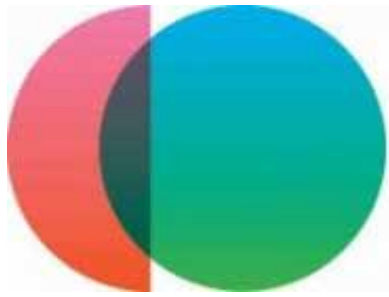

Coverings'20

THE GLOBAL TILE & STONE EXPERIENCE

Partecipazione Collettiva Italiana ICE-Agenzia - Confindustria Marmomacchine - Tecnologia
New Orleans, 20-23 aprile 2020

Ocem SRL	Marmo Elettromeccanica SRL
Achilli SRL	Nuova Mondial Mec SRL
Omar Crane SRL	Boart & Wire SRL

ISLE # 9155 900 sq.ft

30 ft

30 ft



ENTRANCE

ENTRANCE

ENTRANCE

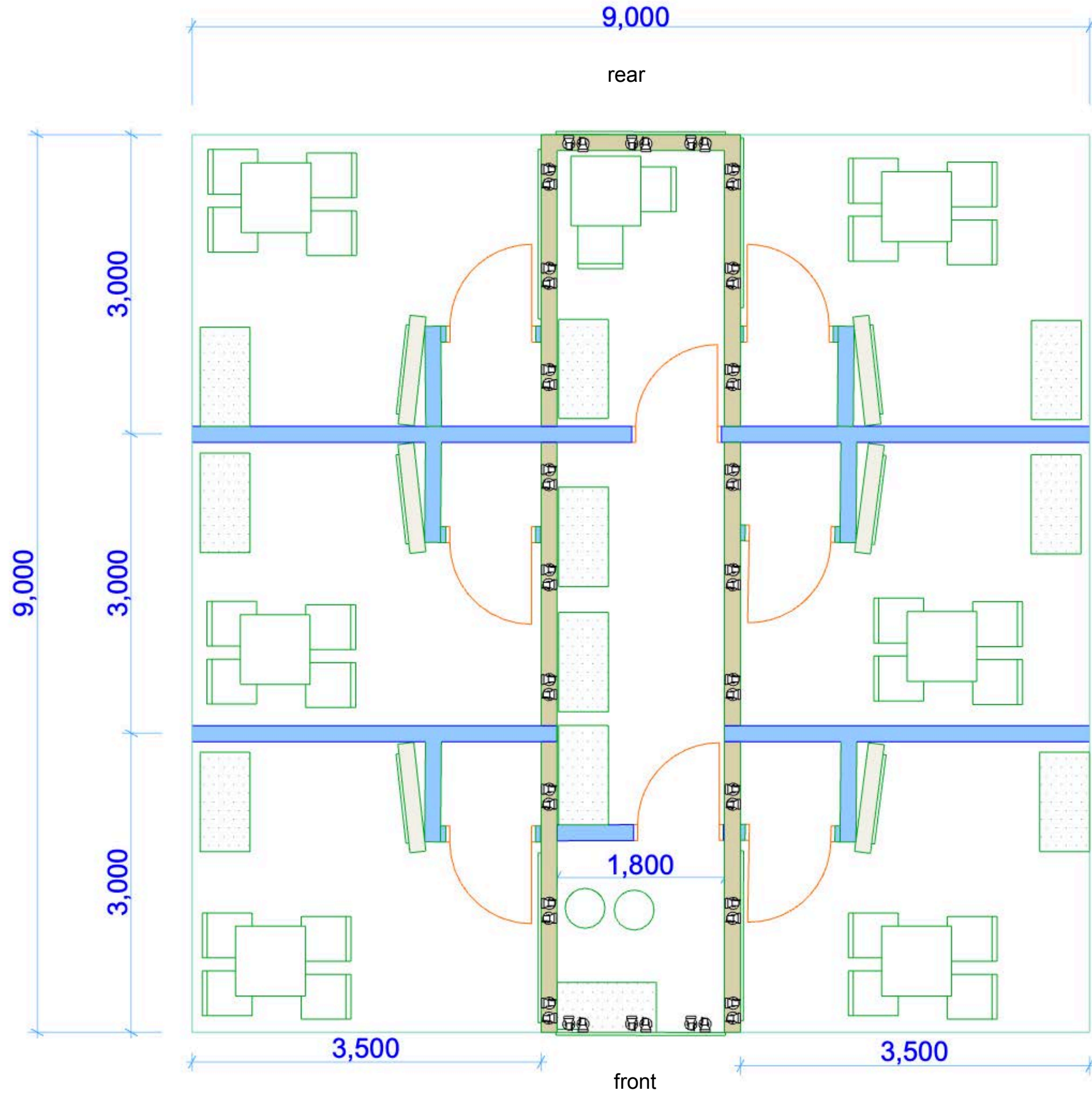

Italian pavilion - General plane

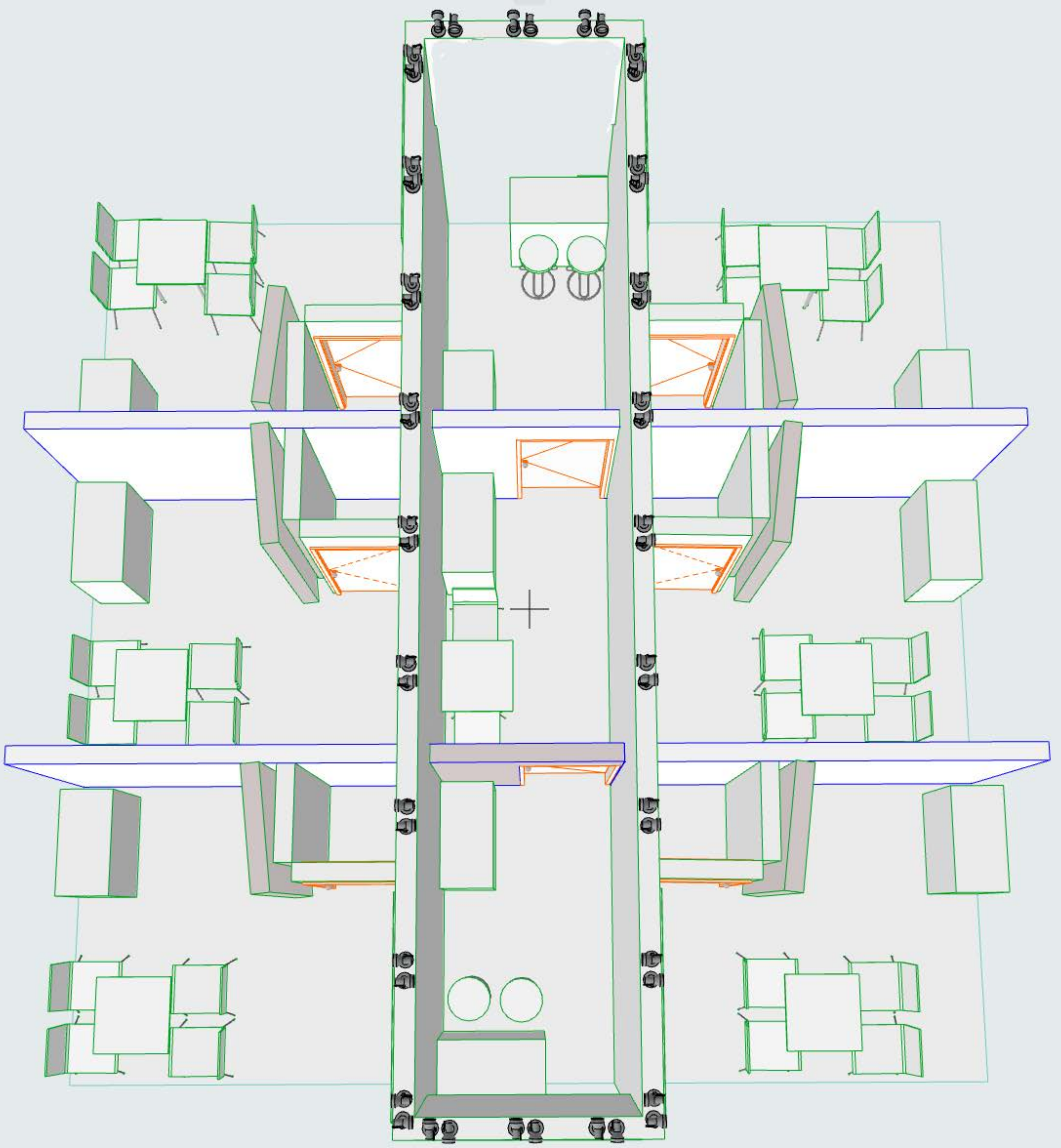



ITALIAN TRADE AGENCY
**ICE - Agenzia per la promozione all'estero e
l'internazionalizzazione delle imprese italiane**

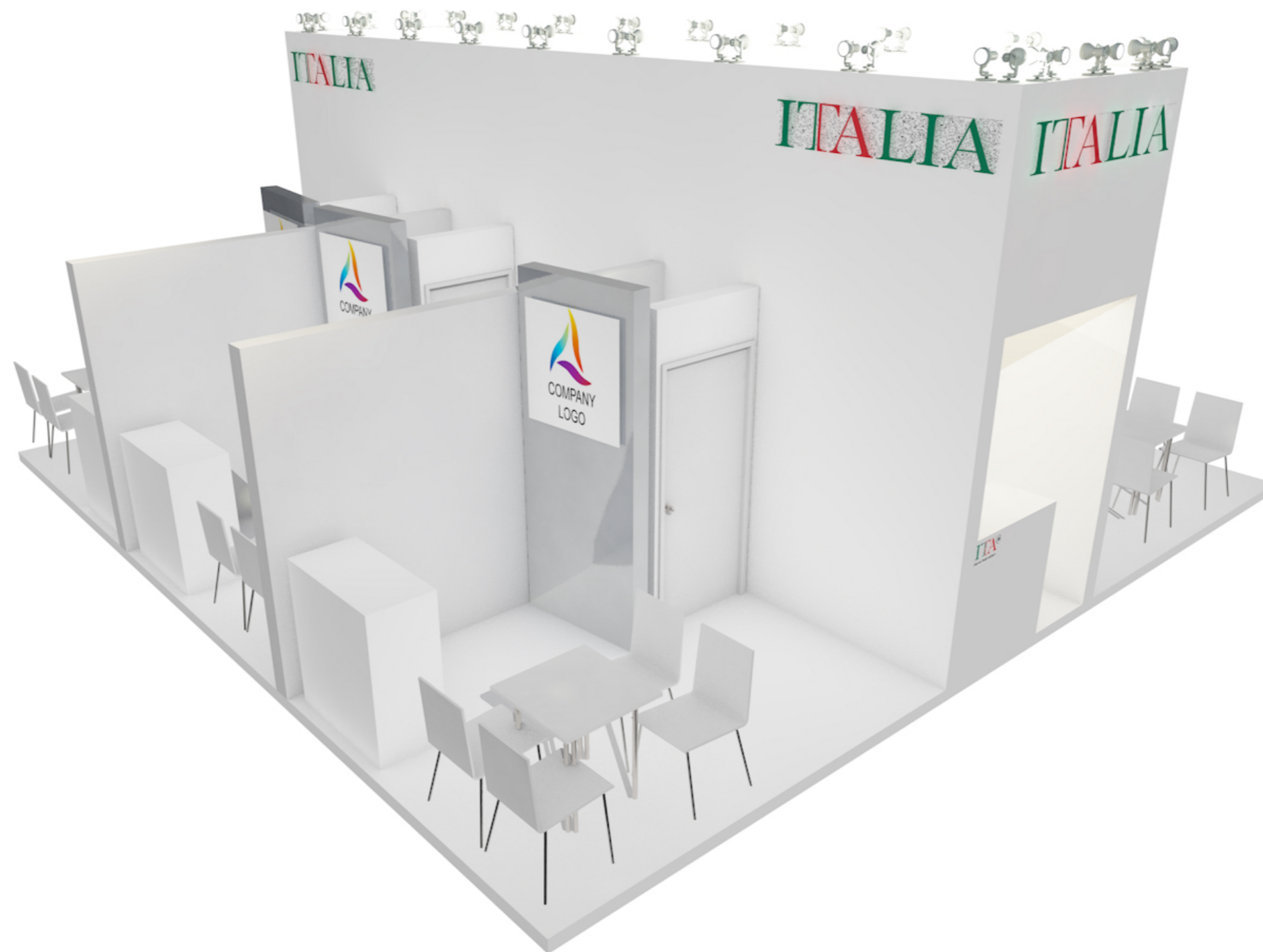



ITALIAN TRADE AGENCY

ICE - Agenzia per la promozione all'estero e
l'internazionalizzazione delle imprese italiane

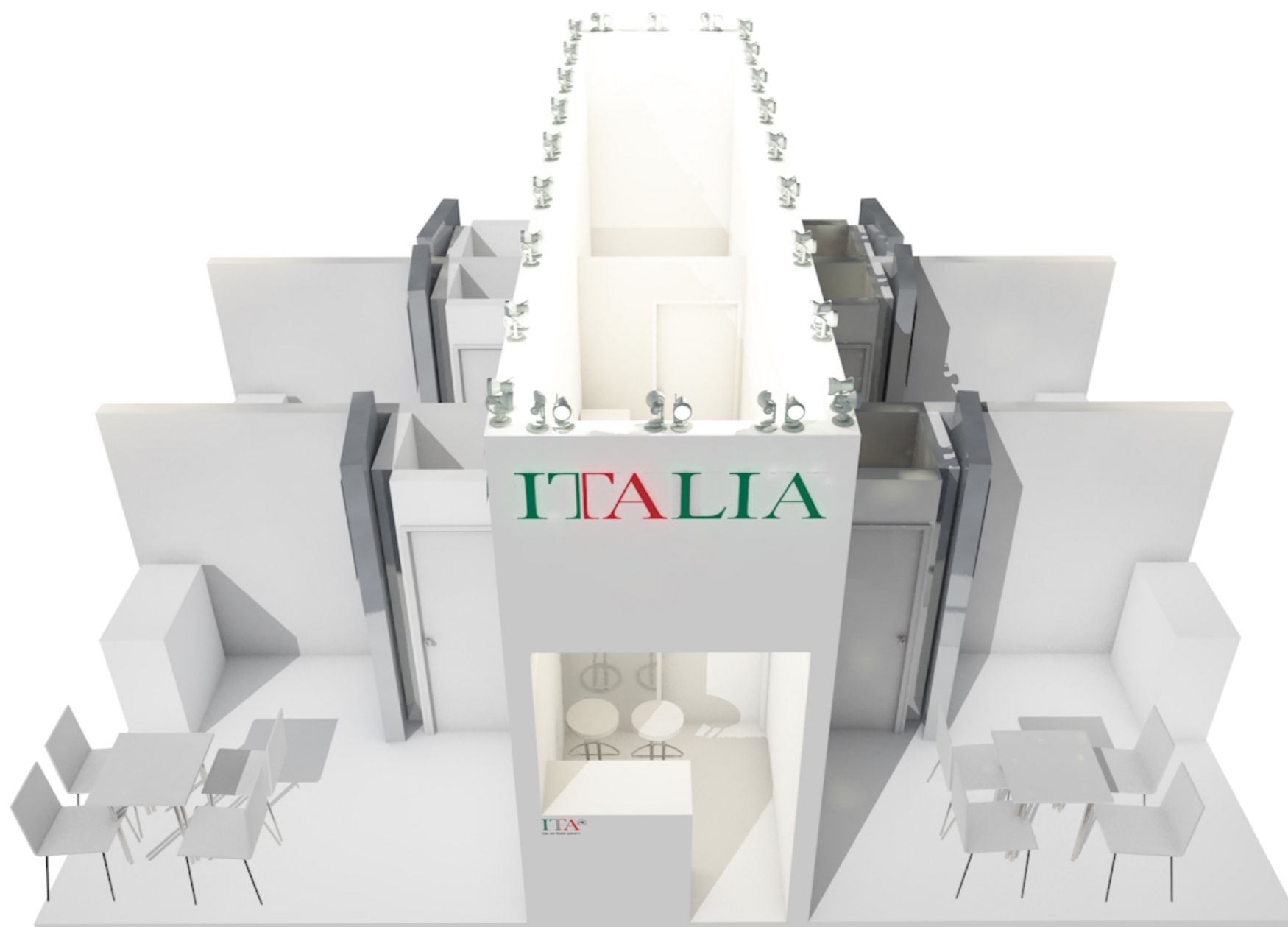

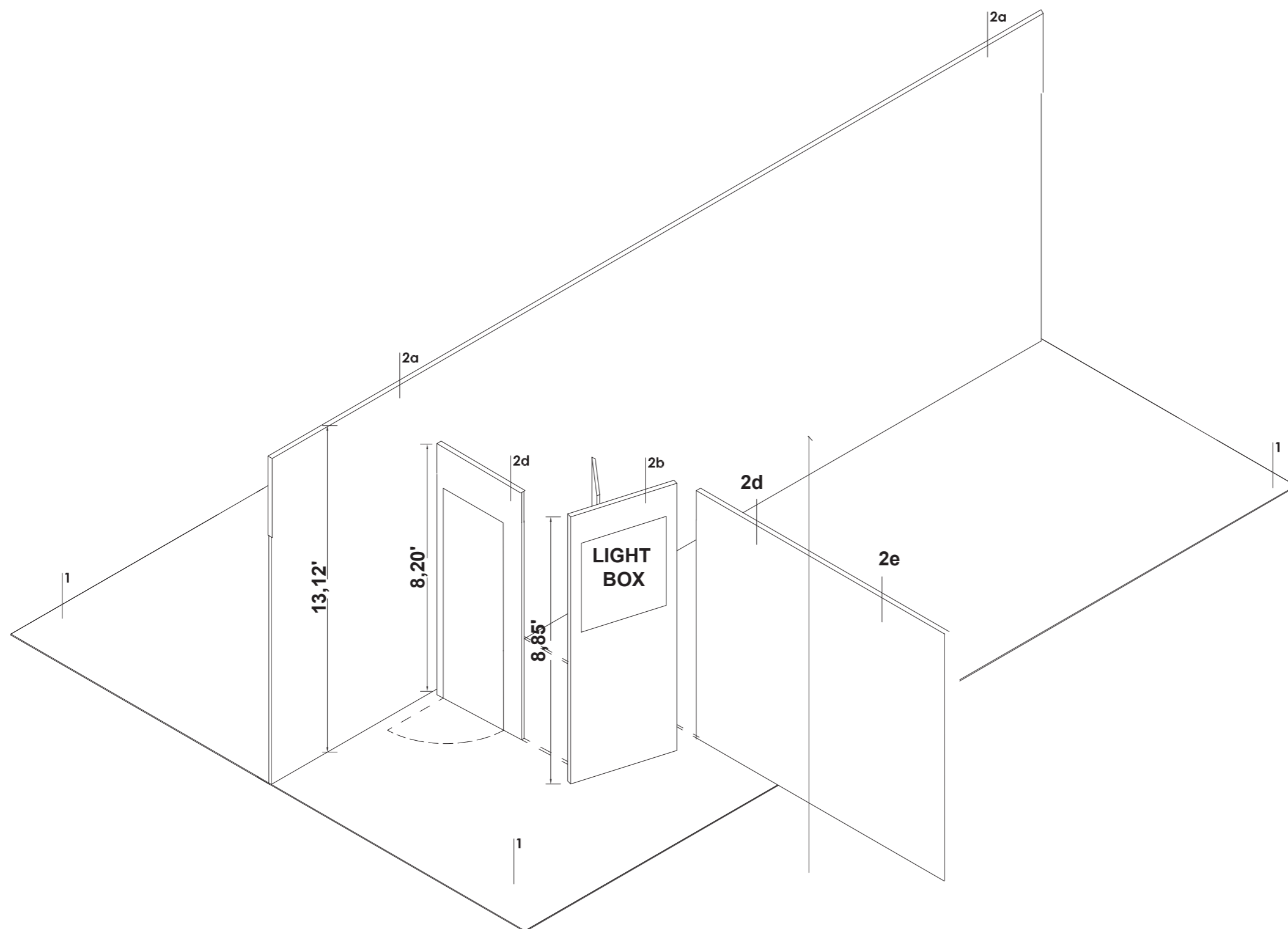

2a_Back Panel 13,12' (400 cm)

2b_Storeroom Panel 8,85' (270 cm)

2d_Partition Panel 8,20' (250 cm)

2e_Light box graphic 8,20' (250 cm)

LIGHT BOX for company name's 2,95' x 2,95' (90 x 90 cm)

Painted Red - Green /10mm/
Illuminated /10mm / Cool White

ITALIA

Back Diod Led Light

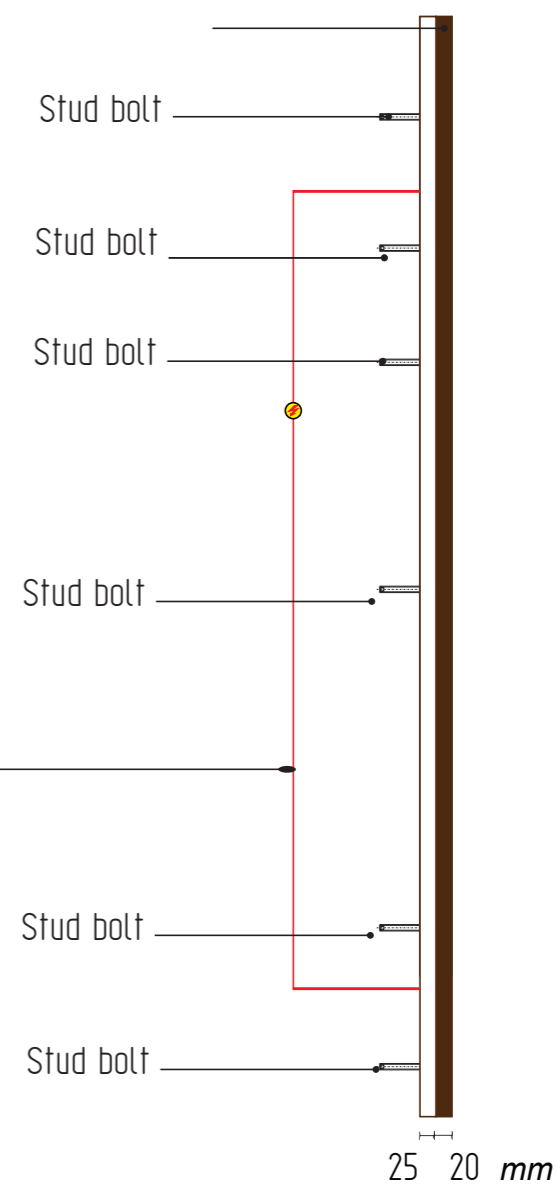

Example backlit LEDs Logo ITALIA Back Panel 2a

graphic panel 2a
G1 - G2 logo



ONLY FOR EXAMPLE - the measures are only approximate

graphic panel 2d
G3 logo



ITALIAN TRADE AGENCY
ICE - Agenzia per la promozione all'estero e
l'internazionalizzazione delle imprese italiane

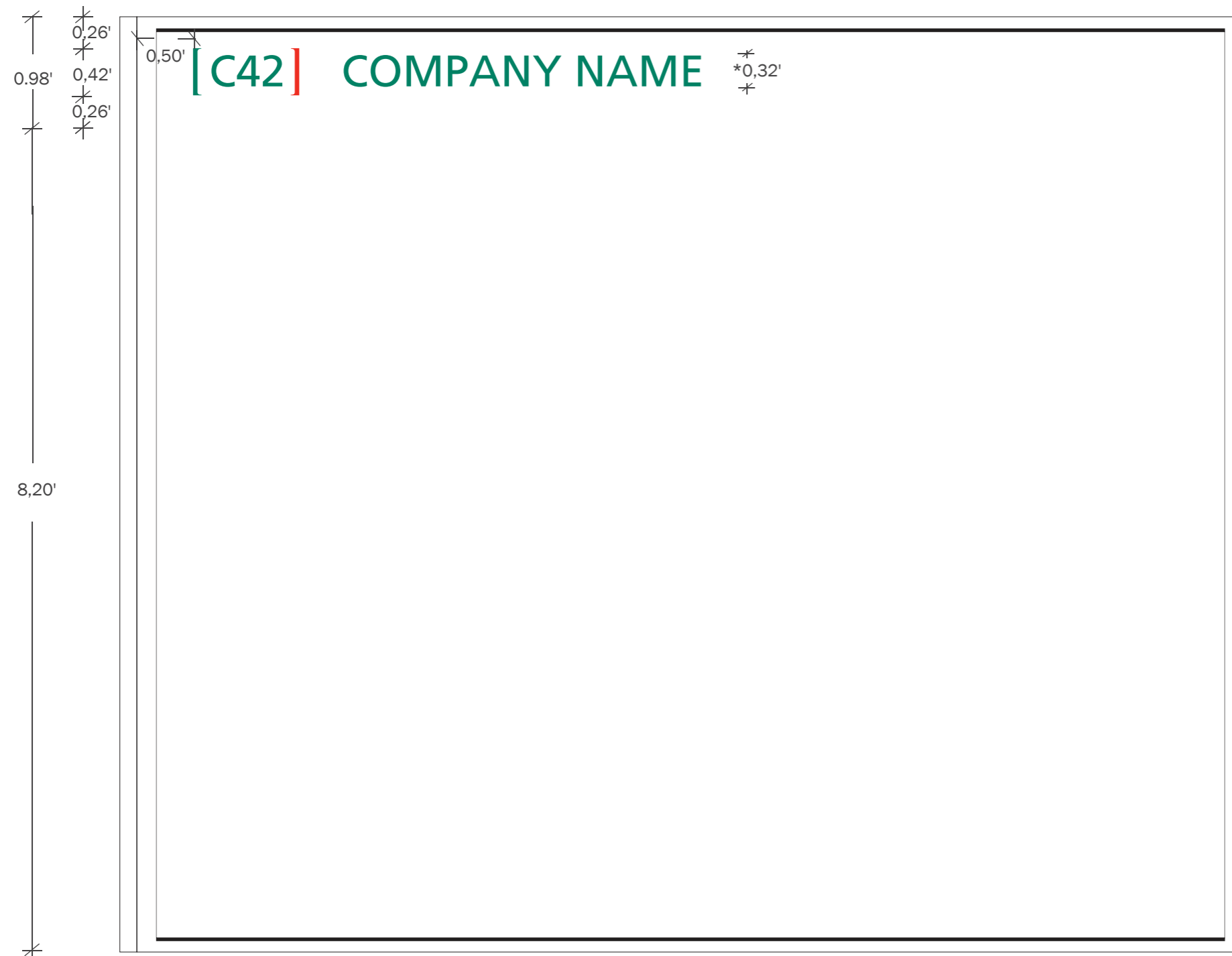

 G3 Booth number + company name

N.B. Font : *frutiger 55 roman
booth number: Capital letter h 9 cm
company name: Capital letter h 9 cm

Green : CMYK 96,5,80,25 Pantone 341C
Red : CMYK 0,96,100,0 Pantone 485C

[C42] COMPANY NAME