

News 2019



imovilli pompe

70
years



DB Series

Modular pumps for
crop spraying



Flexible & Reliable

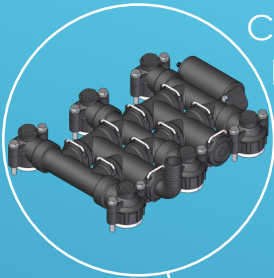

Corrosion-resistant plastic manifolds

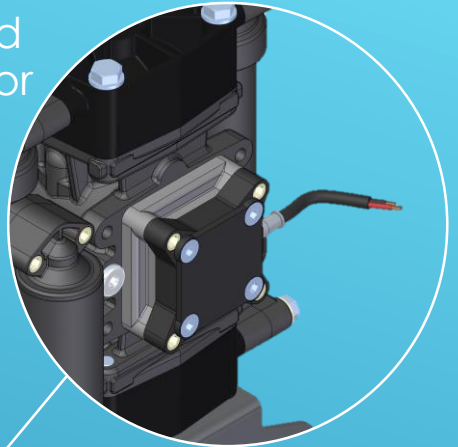

Integrated RPM sensor

Stainless steel nuts and bolts

Connecting rod for smooth operation

Robust cast iron pump body



High torque PM Brushless modular motor

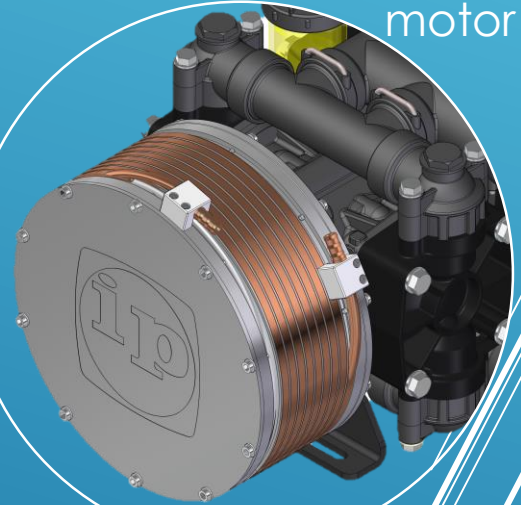

Plastic coated piston heads

Extended life diaphragms

High efficiency check valves

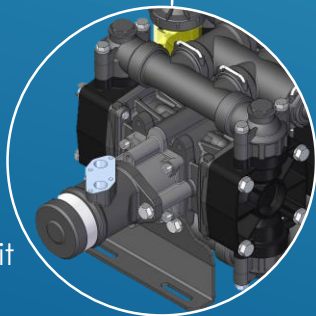

Application kit for hydraulic motors and pumps

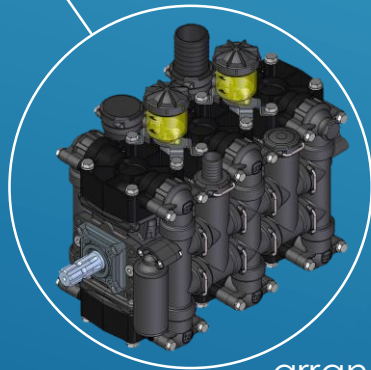

Vertical arrangement for better space optimization

Engineering Friendly

- One only pump for many options

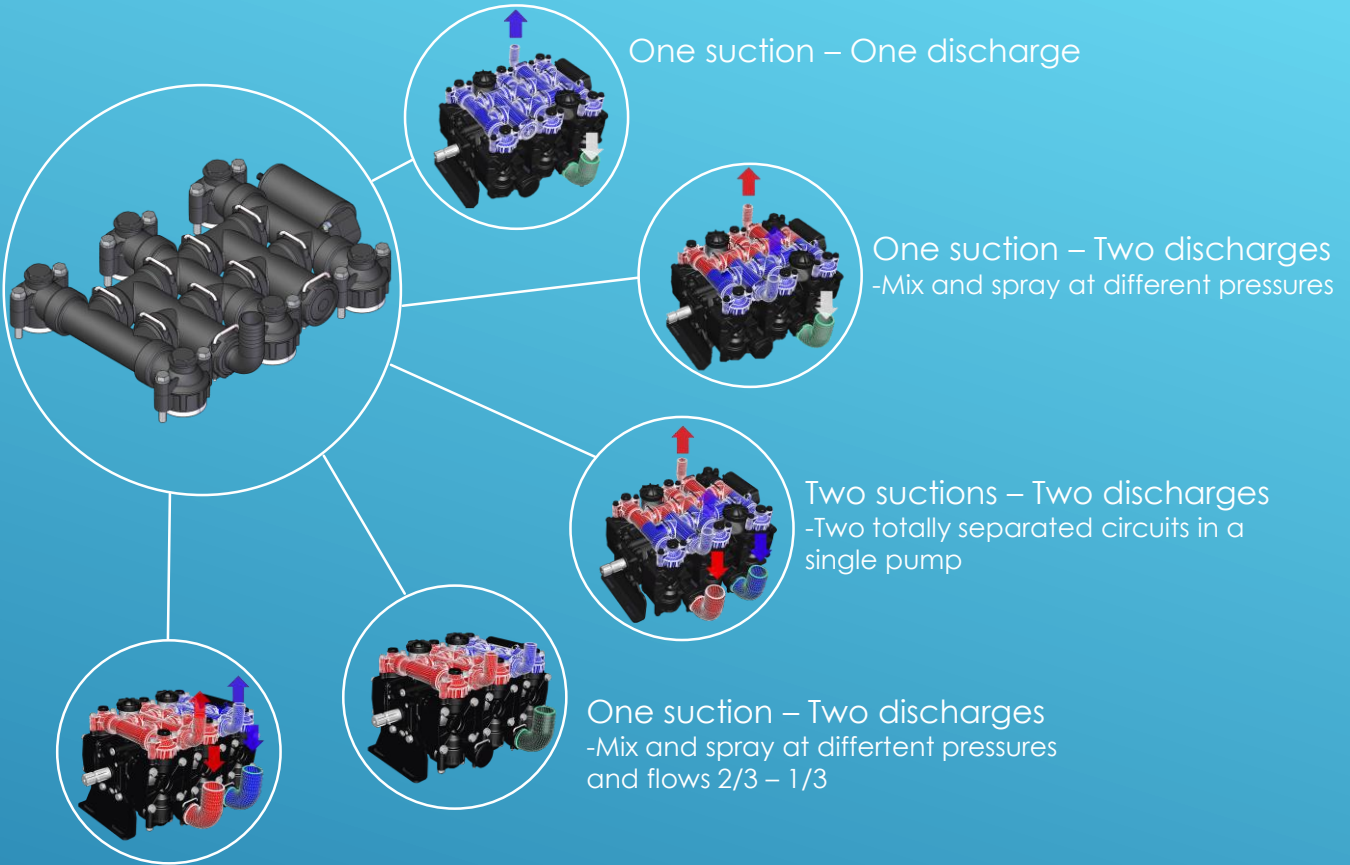

Two suction – Two discharges
-Two totally separated circuits 2/3 – 1/3 flows in a single pump

Maintenance Friendly

- Easy accessible parts



Compact

- A great pump in a small space

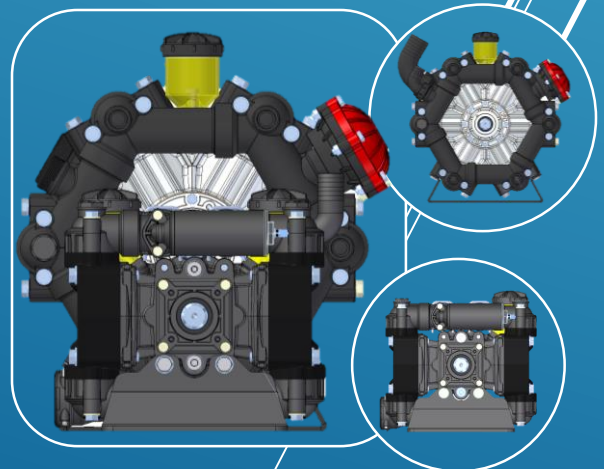

DB 274

Delivery	273 l/1'
Pressure	15 bar
RPM	550
Weight	46 Kg

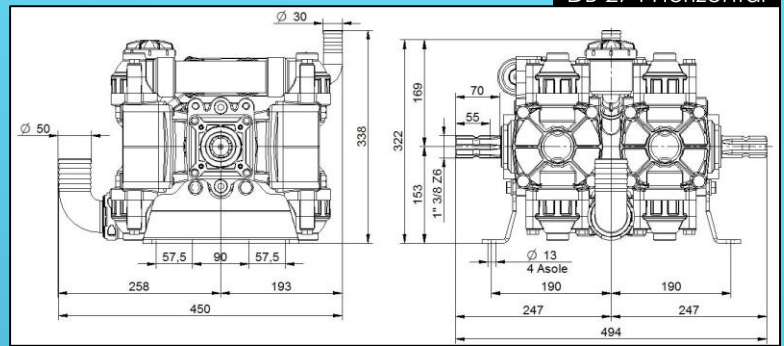

DB 406

Delivery	403 l/1'
Pressure	15 bar
RPM	550
Weight	72 Kg

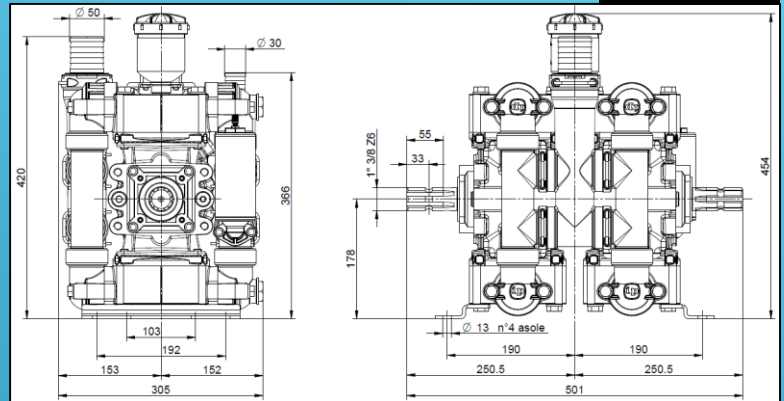

DB 548

Delivery	537 l/1'
Pressure	15 bar
RPM	550
Weight	92 Kg

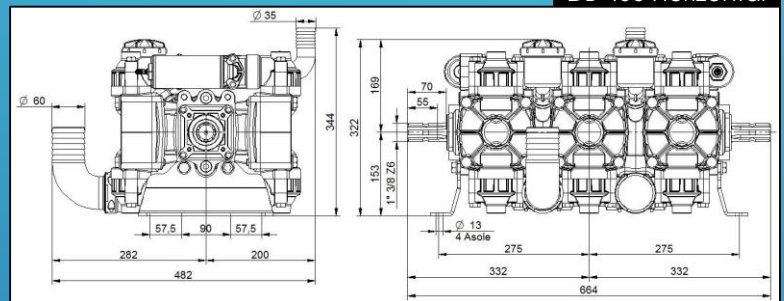

COMPONENTS	MATERIALS
Pump body	Cast iron
Pump head	Plastic coated aluminium
Manifolds	Reinforced resin
Check valve	Stainless steel
Valve cage	Synthetic resin
Pump diaphragm	Nitrile rubber
Dumper diaphragm	Nitrile rubber
Pump shaft	Case - hardened steel

